

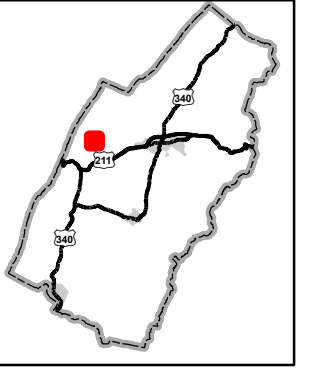

Insert Parcels

Page County, Virginia



- (A)** Acreage Parcels
- (1)** Shenandoah Forest, Section D, E, & F
- (2)** Shenandoah Forest, Section C - P.B. 3, Pg. 185
- (3)** Williams, Alius & Ralph Lawson Land - D.B 30, Pg 144

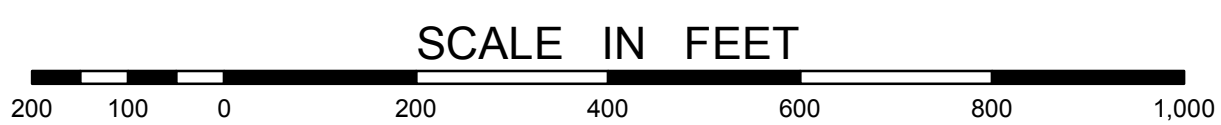
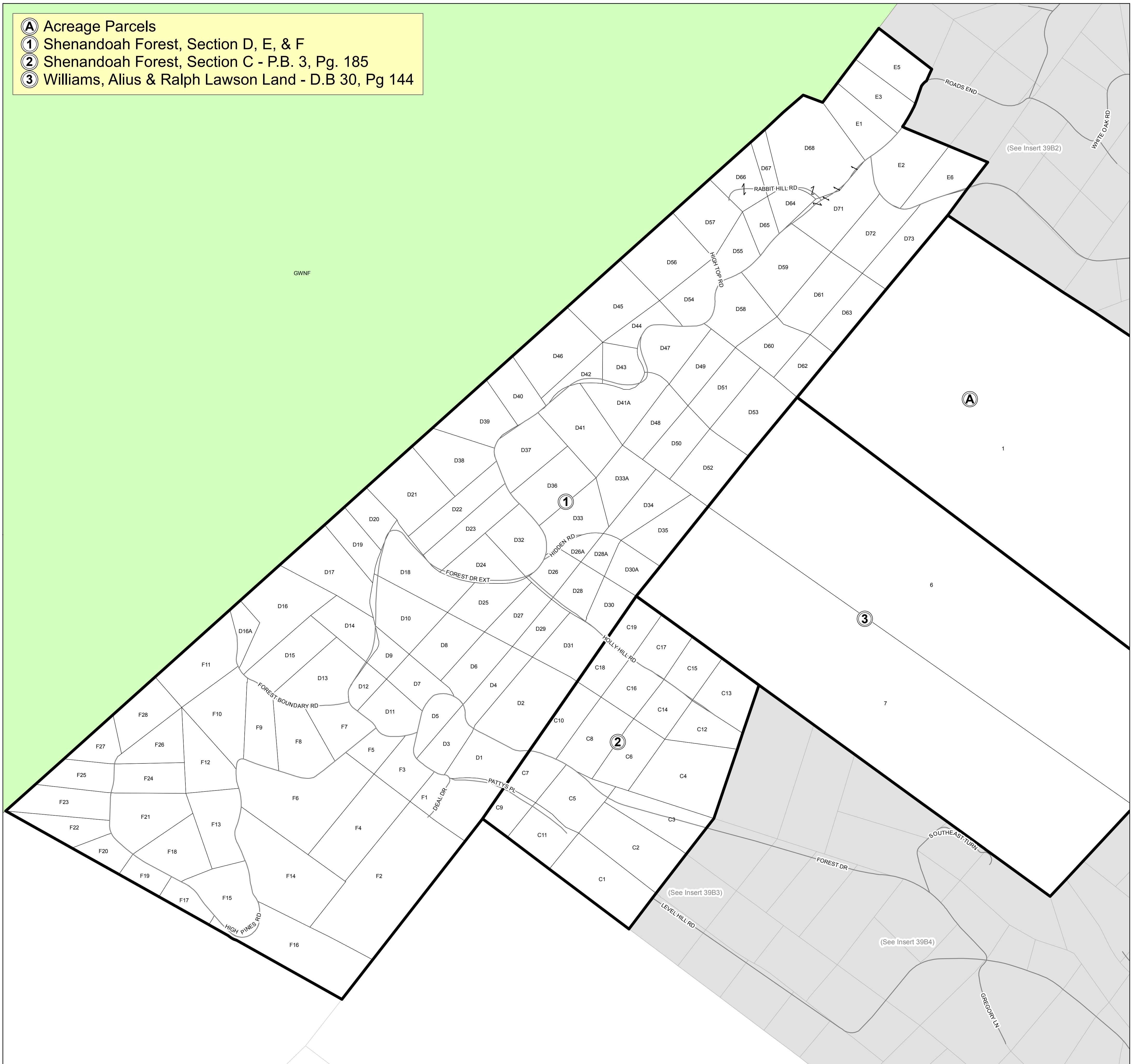

LURAY DISTRICT

May 2019
Commissioner of Revenue
Reference Use Only

Any determination of topography or contours, or any depiction of physical improvements, property lines or boundaries is for general information only and shall not be used for the design, modification, or construction of improvements to real property or for flood plain determination.

**Insert
39B1**